

Dimensions and switching distances

Actuating force: < 150 N (at 23 °C and with testpiece Ø 80 mm)
Dimensional tolerances: DIN 7715 - E2/L2

Safety Edges 2.3.2 Standard Range

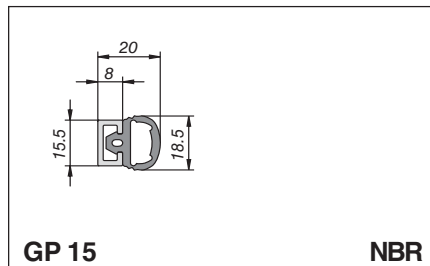

GP 15 **NBR**

Actuation distance:
- at 10 mm/s 2 - 4 mm
Overtravel: -
Al-rail type: C15

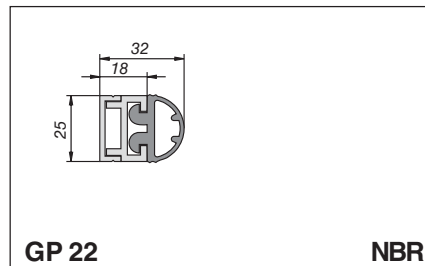

GP 22 **NBR**

Actuation distance:
- at 10 mm/s 5 mm
Overtravel:
- at 10 mm/s 1 mm
Al-rail type: C 25

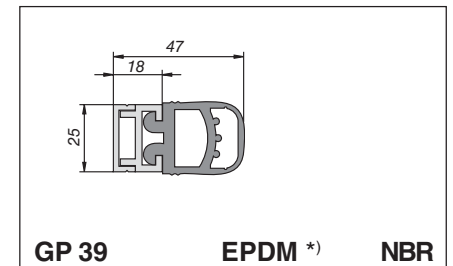

GP 39 **EPDM *)** **NBR**

Actuation distance:
- at 10 mm/s 4 mm 8 mm
Overtravel:
- at 10 mm/s 2 mm 9 mm
Al-rail type: C 25 C 25

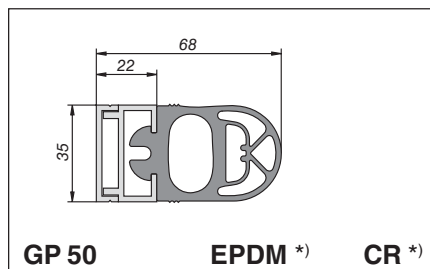

GP 50 **EPDM *)** **CR *)**

Actuation distance:
- at 10 mm/s 9 mm 7 mm
- at 100 mm/s 15 mm 8 mm
Overtravel:
- at 10 mm/s 13 mm 5 mm
- at 100 mm/s 5 mm 4 mm
Al-rail type: C 35 C 35

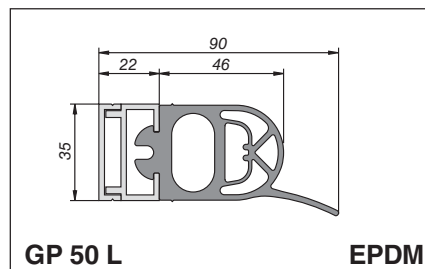

GP 50 L **EPDM**

Actuation distance:
- at 10 mm/s 20 mm
Overtravel:
- at 10 mm/s 12 mm
Al-rail type: C 35

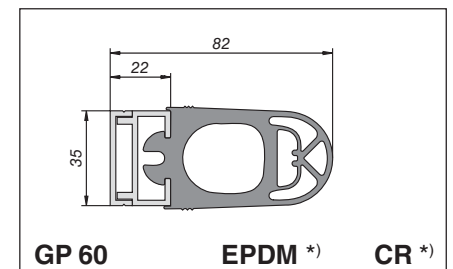

GP 60 **EPDM *)** **CR *)**

Actuation distance:
- at 10 mm/s 7 mm 8 mm
- at 100 mm/s 10 mm 9 mm
Overtravel:
- at 10 mm/s 20 mm 7 mm
- at 100 mm/s 16 mm 6 mm
Al-rail type: C 35 C 35

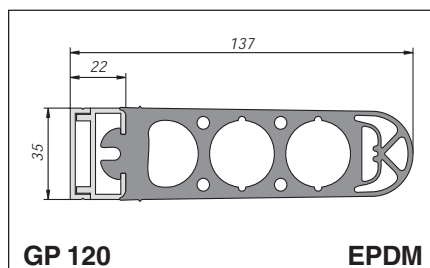

GP 120 **EPDM**

Actuation distance:
- at 10 mm/s 11 mm
Overtravel:
- at 10 mm/s ca. 45 mm
Al-rail type: C 35

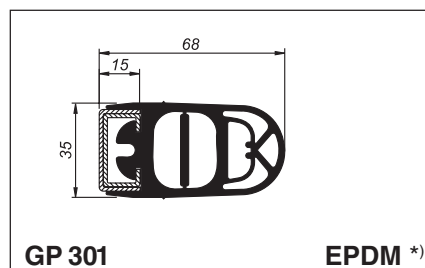

GP 301 **EPDM *)**

Actuation distance:
- at 10 mm/s 12 mm
- at 100 mm/s 12 mm
Overtravel:
- at 10 mm/s 14 mm
- at 100 mm/s 8 mm
Steel rail type: C 27

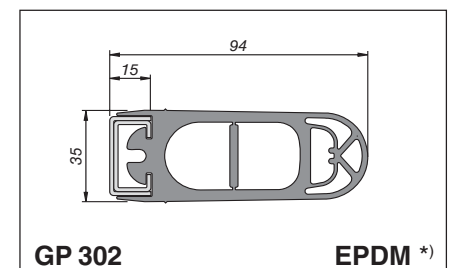

GP 302 **EPDM *)**

Actuation distance:
- at 10 mm/s 10 mm
- at 100 mm/s 12 mm
Overtravel:
- at 10 mm/s 25 mm
- at 100 mm/s 22 mm
Steel rail type: C 27

All given data marked with *) are verified by EEC-type-examination certificates.

Subject to technical modifications.